



union station

shooting locations
A PHOTOGRAPHER'S GUIDE

LEGEND

 = FEATURED IN THIS GUIDE

 = RESTROOMS

 = ELEVATOR



WELCOME TO
union station

As a ShutterFest attendee, you enjoy unprecedented access to Union Station. That means you can shoot pretty much anywhere! But... where should you go? We've put together this guide to our favorite photo spots. Enjoy!

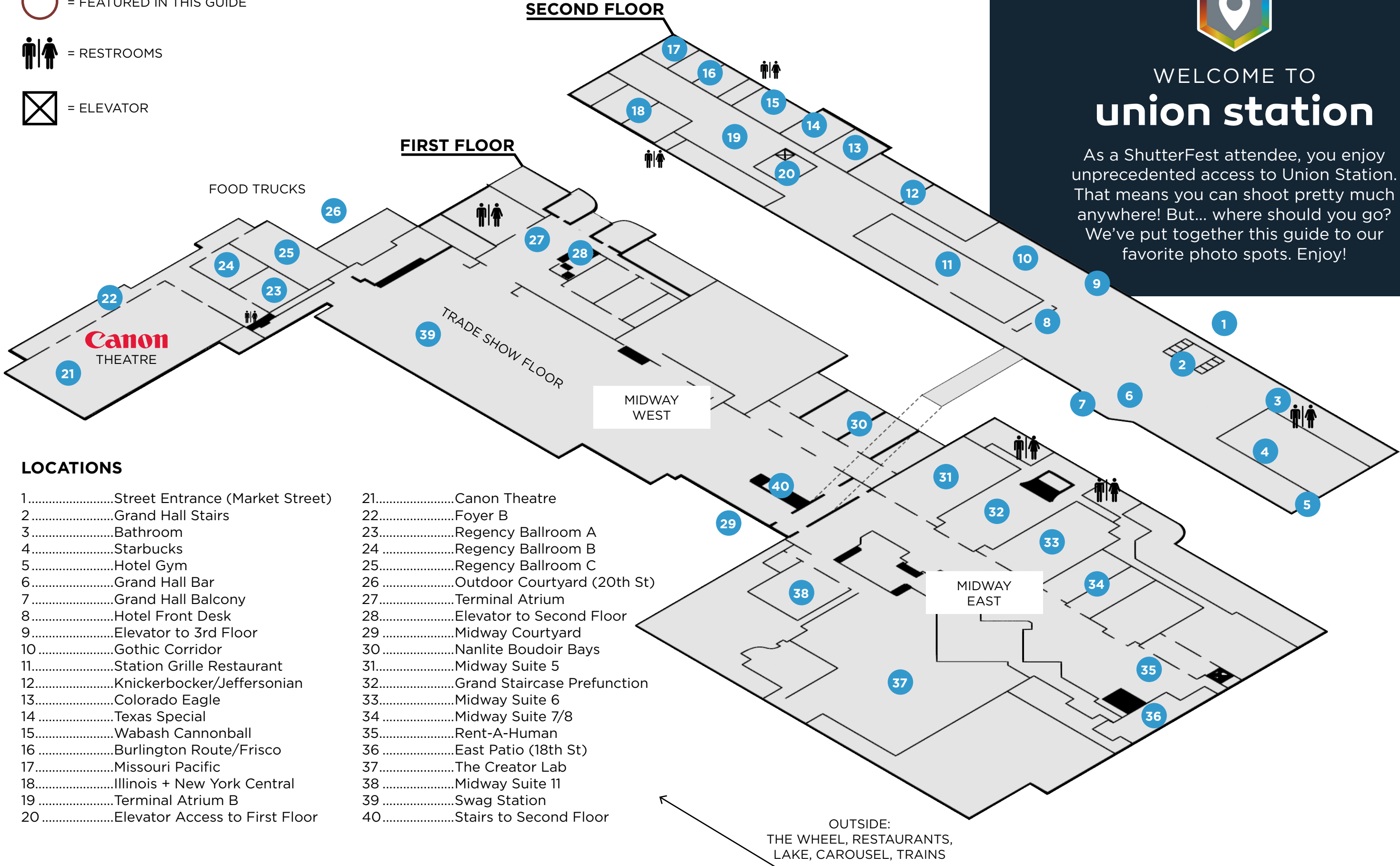

LOCATIONS

- | | |
|---------------------------------------|------------------------------------|
| 1.....Street Entrance (Market Street) | 21.....Canon Theatre |
| 2.....Grand Hall Stairs | 22.....Foyer B |
| 3.....Bathroom | 23.....Regency Ballroom A |
| 4.....Starbucks | 24.....Regency Ballroom B |
| 5.....Hotel Gym | 25.....Regency Ballroom C |
| 6.....Grand Hall Bar | 26.....Outdoor Courtyard (20th St) |
| 7.....Grand Hall Balcony | 27.....Terminal Atrium |
| 8.....Hotel Front Desk | 28.....Elevator to Second Floor |
| 9.....Elevator to 3rd Floor | 29.....Midway Courtyard |
| 10.....Gothic Corridor | 30.....Nanlite Boudoir Bays |
| 11.....Station Grille Restaurant | 31.....Midway Suite 5 |
| 12.....Knickerbocker/Jeffersonian | 32.....Grand Staircase Prefunction |
| 13.....Colorado Eagle | 33.....Midway Suite 6 |
| 14.....Texas Special | 34.....Midway Suite 7/8 |
| 15.....Wabash Cannonball | 35.....Rent-A-Human |
| 16.....Burlington Route/Frisco | 36.....East Patio (18th St) |
| 17.....Missouri Pacific | 37.....The Creator Lab |
| 18.....Illinois + New York Central | 38.....Midway Suite 11 |
| 19.....Terminal Atrium B | 39.....Swag Station |
| 20.....Elevator Access to First Floor | 40.....Stairs to Second Floor |



grand hall lobby

BATHROOM ARCH

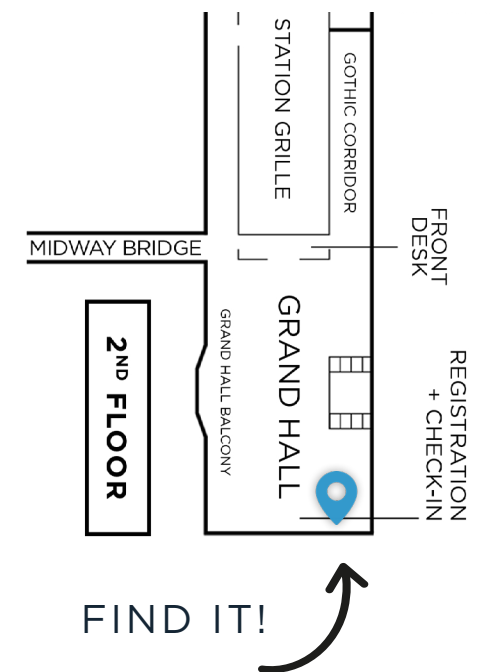

Image © Curtiss Bryant

Image © Carolina Waldroff Photography



If this isn't the most photographed bathroom entrance in the country, it's certainly the most photogenic.





grand hall balcony

IVY ARCHES

The unassuming entrances on either side of the Grand Hall Lobby Bar conceal this great photo location.

Perfect for fantasy shoots, fashion or beauty work, and anything in between.

TIP: try using gels to change the look of the ivy!

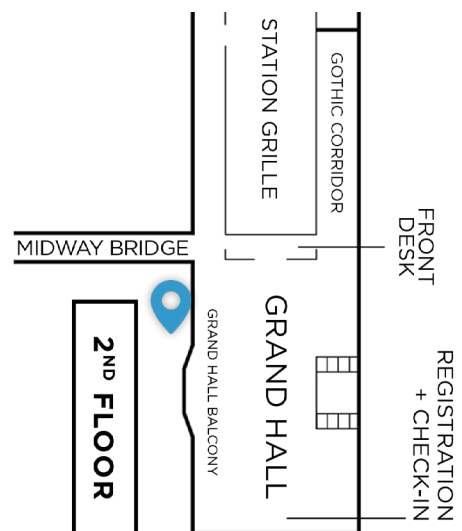

FIND IT!



Image © Artemis Photo



Image © Throwback Photography



grand hall

THE GOTHIC CORRIDOR



Image © Ivan Duran Photography

Image © Tim Goates Photography



Choose your flavor:
light and airy using the
gorgeous natural light of
this hallway, or dark and
dramatic to play up the
rich colors.

Find this location on the
right hand side of the
hotel's front desk.

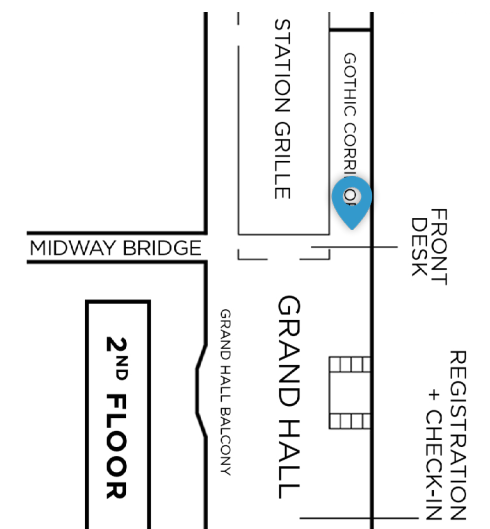

FIND IT!



grand hall

BALCONIES ABOVE THE LOBBY

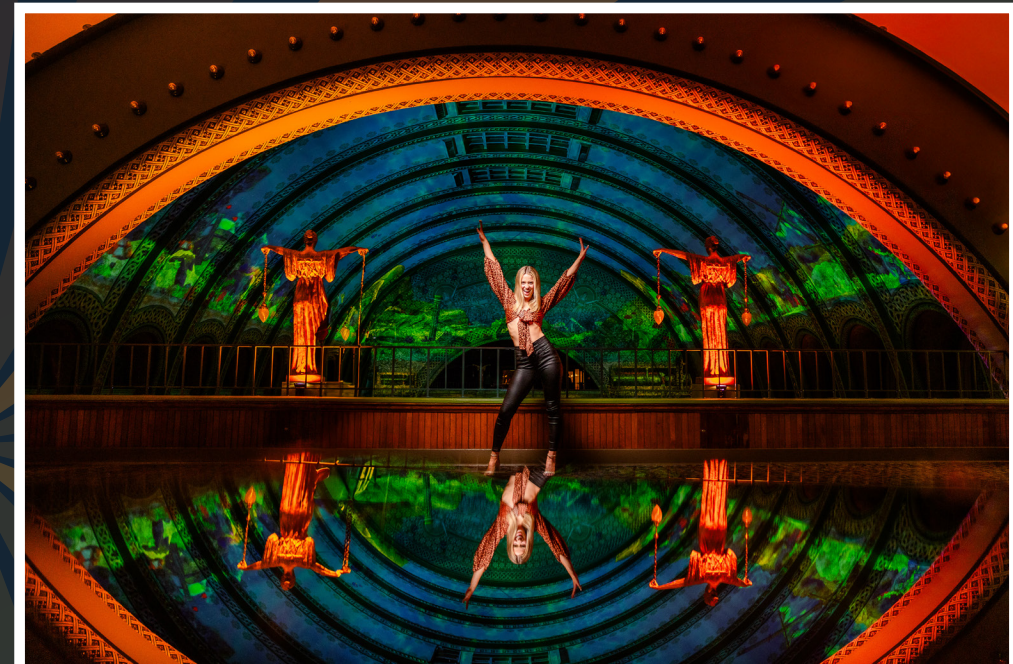

Image © Michelle Jahns Photography



Image © Jeff Goldberg Photography



Image © Eric Burke

Another ornate arch?
Groundbreaking. But
hear us out: head up the
elevator to the landings
above the Front Desk
lobby to capture this
unique perspective of
Union Station.

Pro Tip: plan a shoot up
here in the evening if you
want to capture the night
time light show in the
background!

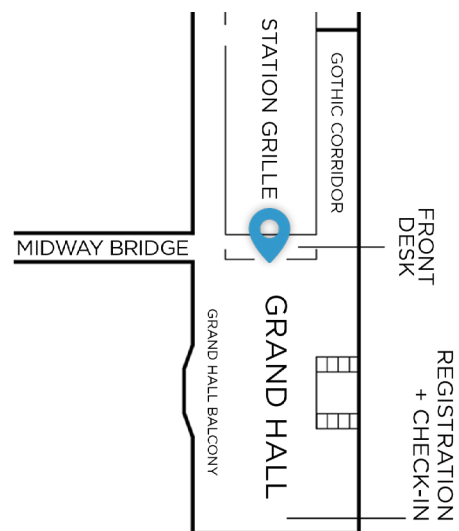

FIND IT!



terminal atrium

THE LIGHT UP FLOOR



Image © Silver Bear Studio

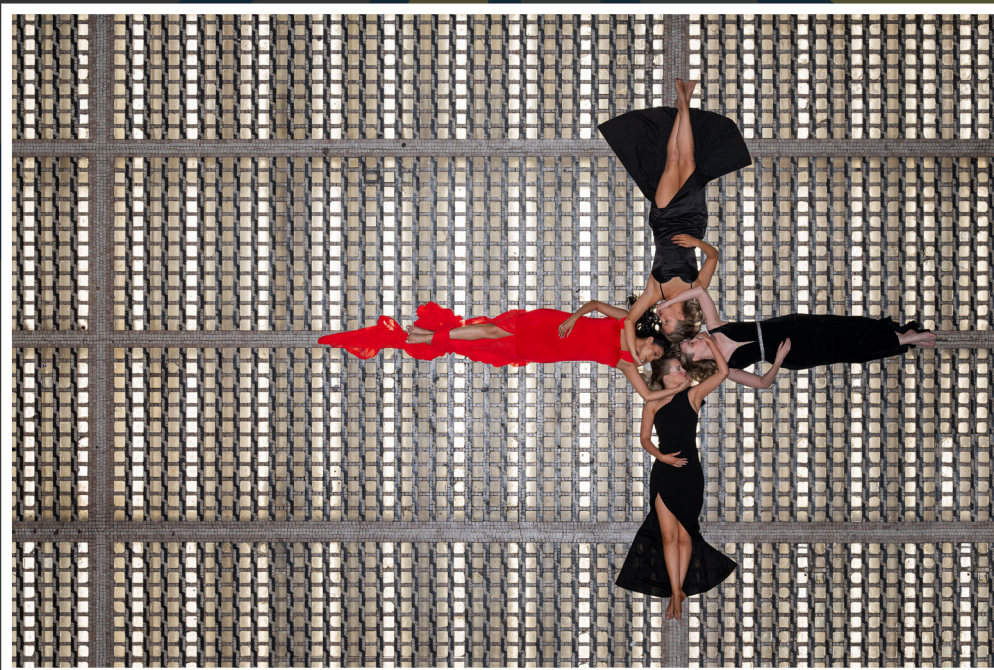
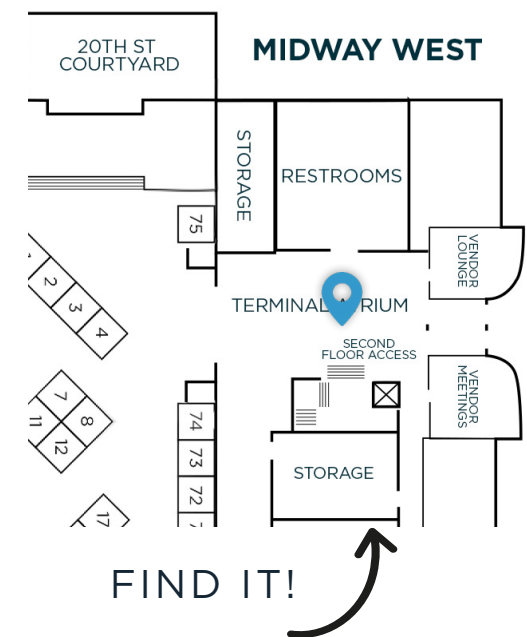

Image © Ragu Like The Sauce Photography

Image © Evening Sstar Photography



It's historic. It's iconic. *It freakin' lights up.* Do we need to say more? We can feel the creative wheels turning just thinking about it.





outside

THE TRAINS

Hello, leading lines and urban grit. If you don't get a shot near these, *did you even go to ShutterFest?*

**Attendees can shoot around the trains, but please do not climb on them during trade show hours. Permission must be obtained after hours from Union Station. Going inside the trains is not permitted.*

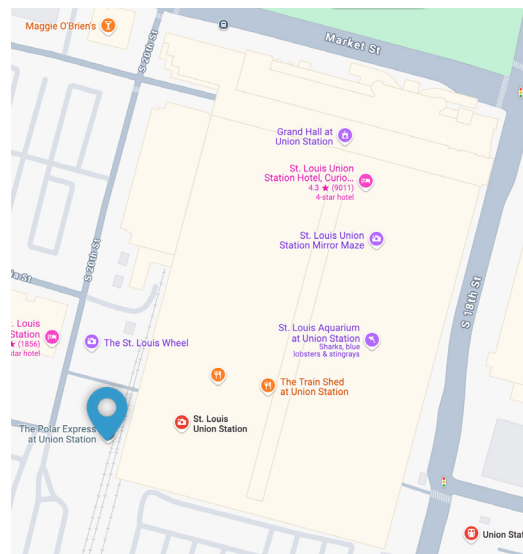

FIND IT!



Image © LettyDesvigne



Image © Acting Natural Expressions



outside

THE FERRIS WHEEL

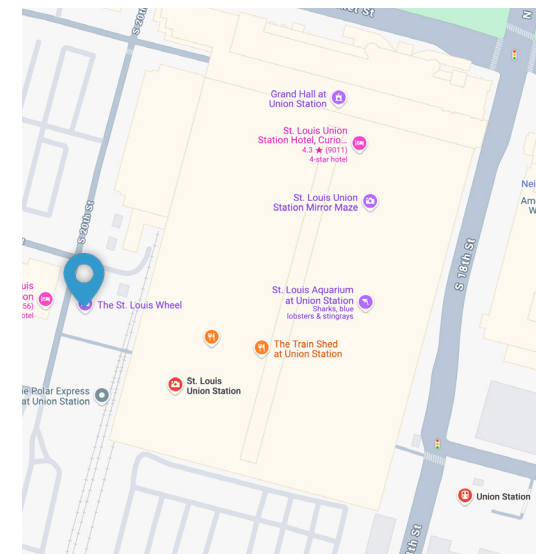

Image © Carolina Waldroff Photography

Image © JRenee Photography



Step outside after hours to play with long exposures and color at the newest addition to Union Station: The St. Louis Wheel!



FIND IT!





outside

LAKE & CAROUSEL AREA

Explore the outdoor area of Union Station and photograph near the lake, (pro tip: head there at night time for the Fire & Ice show!) carousel, taco container, vintage Soda Fountain restaurant, or Landry's seafood restaurant.

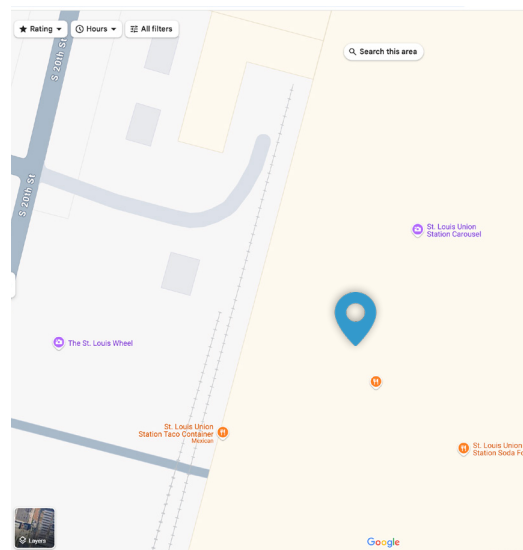

FIND IT!



Image © shotWRIGHTstudios



Image © Steel Veils



Image © Story Photography by Selena LLC



MORE LOCATIONS
go explore!

There are so many more locations to photograph at Union Station - inside and out. *(and we didn't even mention the grand pianos!)* So start exploring and see if you can find some of these!



Image © Stacy Kennedy Photography



Image © ChristianBerensPhotography



Image © Jeff Goldberg Photography



Image © Stacy Kennedy Photography



Image © Diana Lynn Photography



Image © Laura Dark Photography



Image © Hunter Scott Imagery